



Your ticket to *freedom*



TOURA



The trusted Name in Australia for over 70 years

Australian Made · Australian Owned · Australian Tough · For Over 70 years

From humble beginnings in a small factory located in Mortlake, NSW to today, Millard Caravans is one of Australia's most respected and highly regarded caravans with a **proven track record since 1947**. After all this time we're still one of the best caravan manufacturers in Australia, with all Millard Caravans hand-built in our Ingleburn, Sydney factory.

We pride ourselves on **value for money**. We make sure our caravans have everything you need, plus that little extra luxury that you deserve. **Quality** is at the core of everything we do. We only work with the best of the best and source the highest quality materials, finishes and appliances, just for you.

Our **customer service** is what sets us apart. We're always finding ways to put you first and help you to make the best decisions so we can build your dream caravan together. Using **cutting edge manufacturing** techniques and materials, our architecturally designed caravans are built to reflect your tastes and the lifestyle you want to live.

5 year Structural + 2 year Manufacturing warranty

All Millard Caravans are built to last with a hot dipped galvanised chassis, an Aluminium structural wall frame and full piece composite roof.

This gives you peace of mind in the longevity of the life of your quality-built Millard caravan which is backed by our commitment and promise of a 5 year Structural and 2 year Manufacturing warranty*.

Millard Caravans are accredited by RVMAP, the official accreditation key of the caravan industry. The RVMAP accreditation key is a symbol of a manufacturer's commitment to consistently build and supply quality products that adhere to all relevant Australian design rules, regulations and standards.

*Warranty period commences from the date of purchase and is effective for all new caravans built from January 2020 onwards. Terms and Conditions apply.



TOURA

The Toura range

The semi off-road Toura is Millard's latest range, designed for families and couples looking for a feature-packed van at an affordable price.

Built with our signature hot-dipped galvanised chassis, single-sheet roof, independant CRS suspension and aluminium frame, the Toura's uncompromising quality makes it the ultimate companion on your family holidays.

Select upgrades and styling options are available across our standardised couple and bunk models.



Toura 18ft

Exterior

Built with our signature hot-dipped galvanised chassis, single-sheet roof, aluminium frame and CRS suspension, the Toura has been designed for the explorer who wants to travel endless dirt roads in the Australian outback.

The Toura will take you places remote and surreal without sacrificing any comfort as the list of inclusions is endless. All Toura's are fitted with a 160w Solar Panel, External Awning, Reversing Camera, Toolbox and External speakers.

High black checkerplate and the high ground clearance from the CSR suspension ensures easy towing and protects your investment from the harsh rugged conditions during your travels.

For a full list of all standard inclusions and options please view the Specifications list in the back of this brochure.

Exterior decals on all Toura models can be selected in one of four specially designed colour schemes.

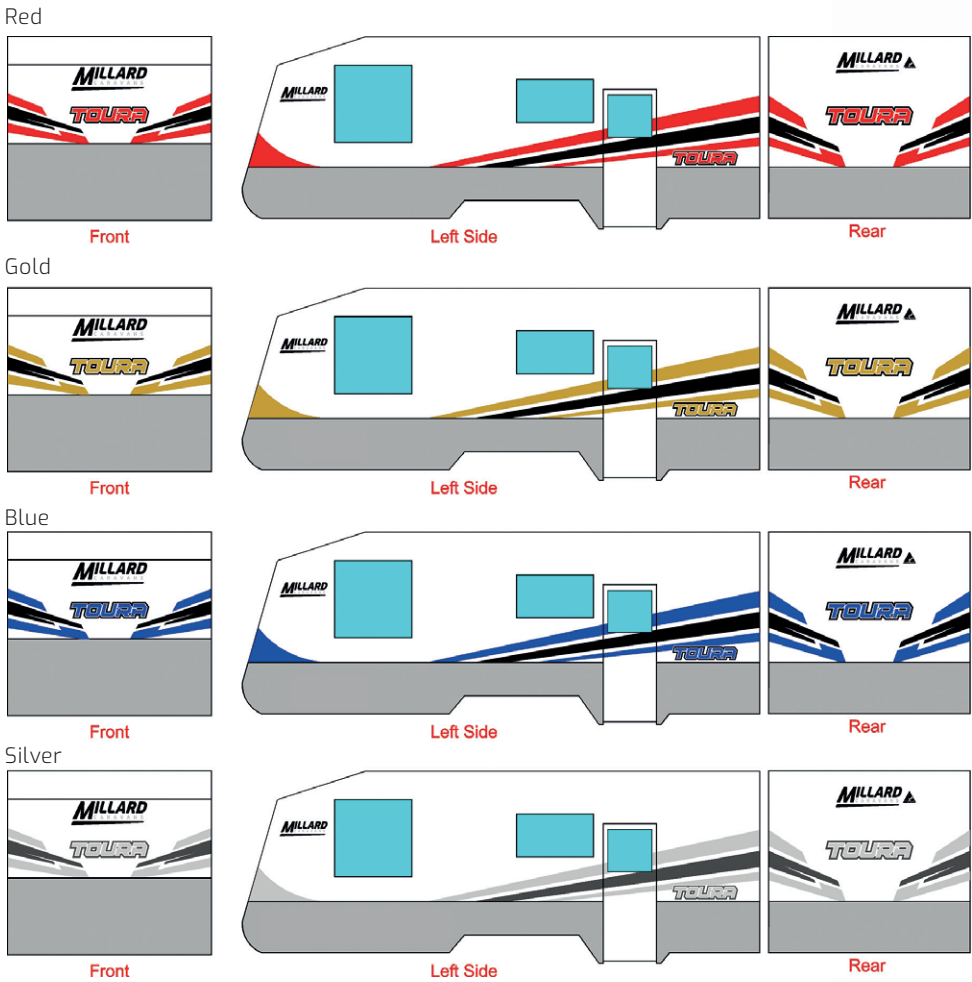

Layouts

Toura 16ft 9 Centre Door (CD) L-Lounge

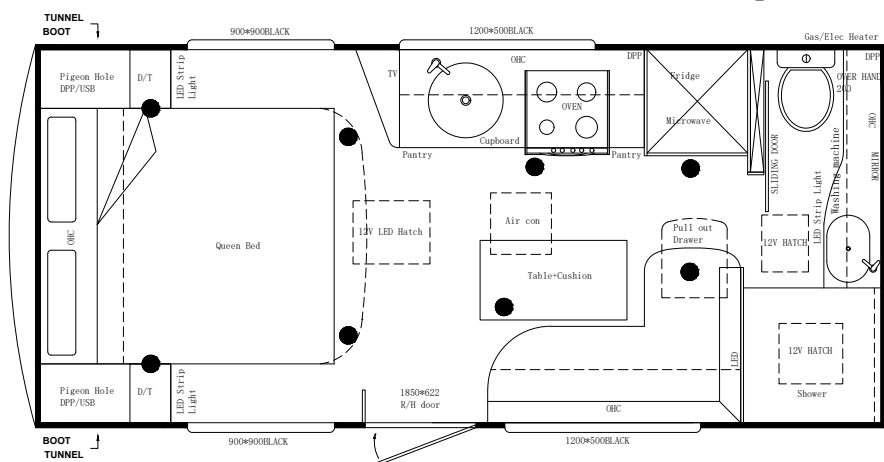

Also available in Pop-top

Toura 17ft 6 Centre Door (CD) L-Lounge

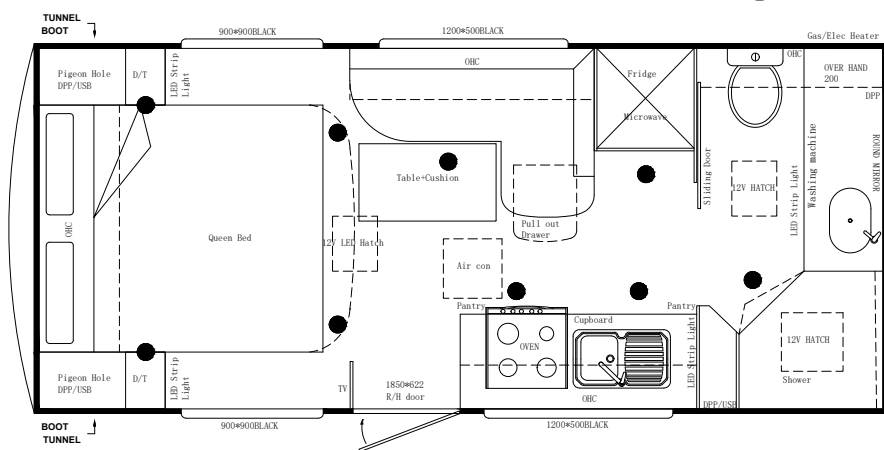

Toura 17ft 6 Rear Door (RD) L-Lounge

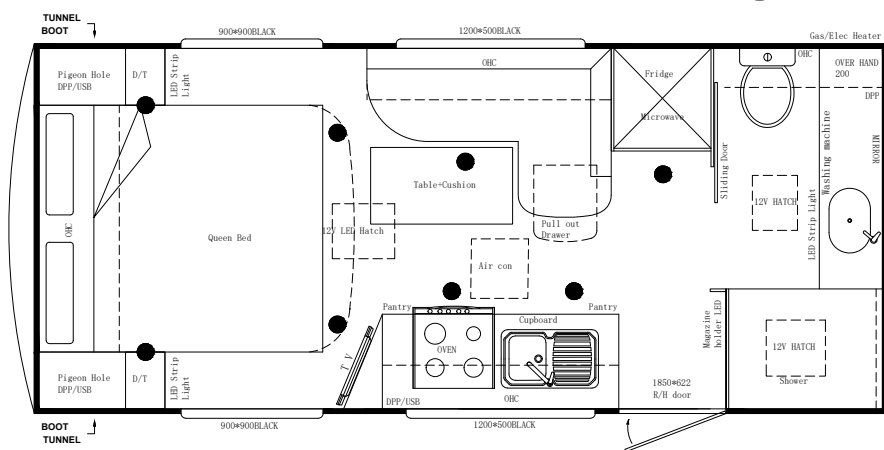

Also available in Pop-top

Toura 18ft 2 Rear Door (RD) L-Lounge

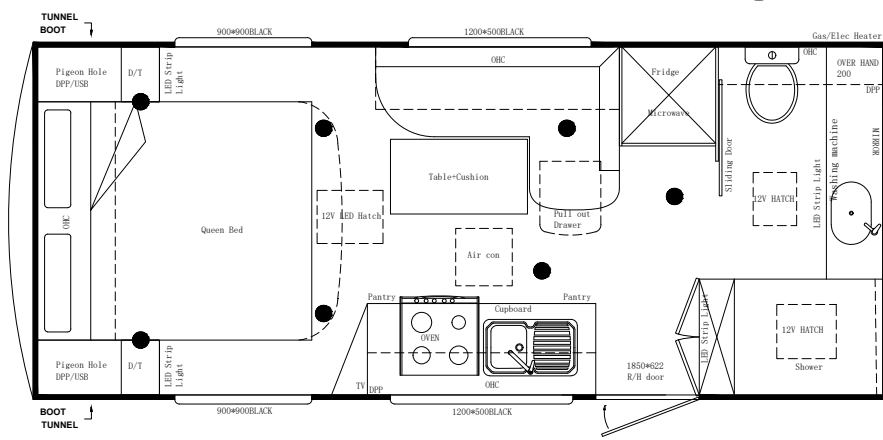

Also available in Pop-top

Toura 18ft 8 Rear Door (RD) Dinette

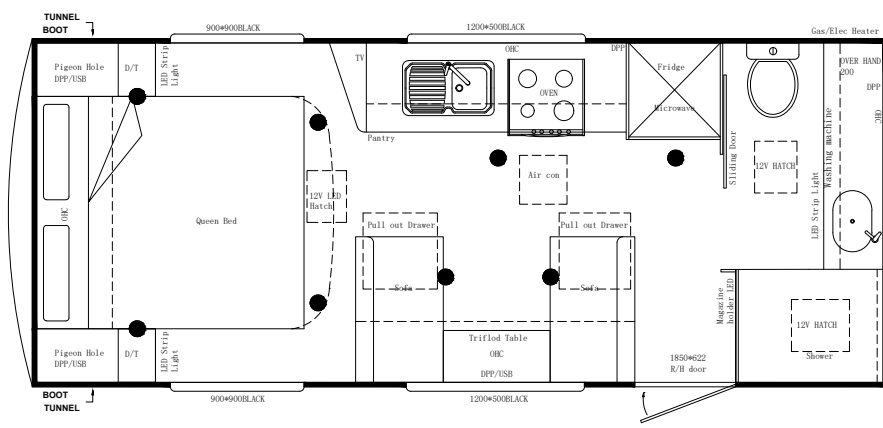

Toura 19ft 6 Rear Door (RD) Dinette

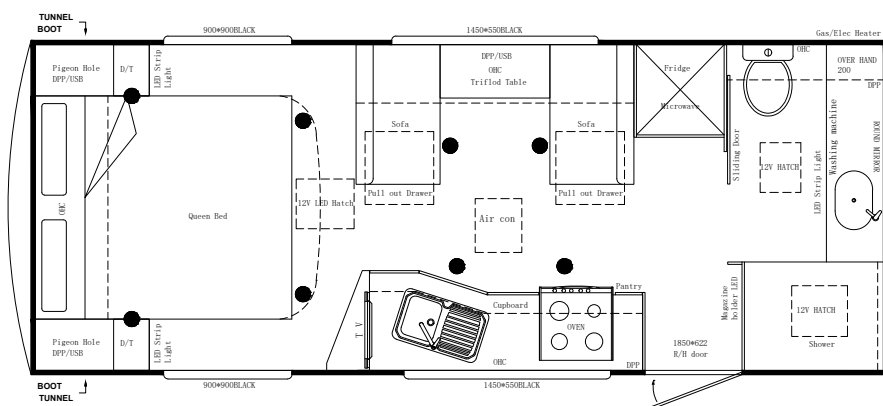

Layouts

Toura 20.2ft Rear Door (RD) Side Club Lounge

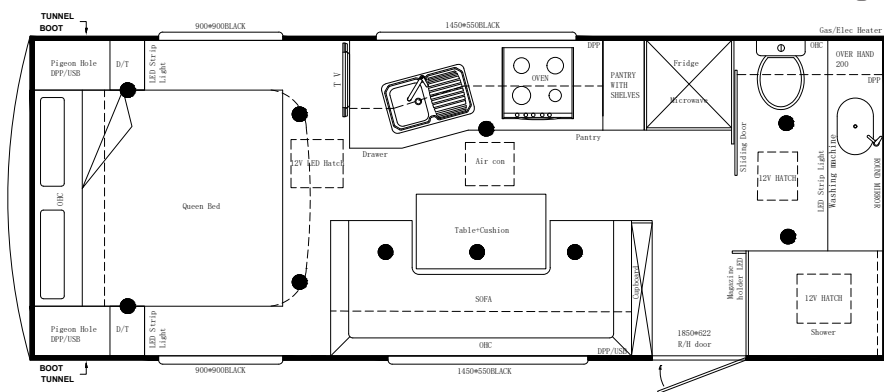

Toura 20ft 2 Rear Door (CD) Dinette Angled Kitchen Option

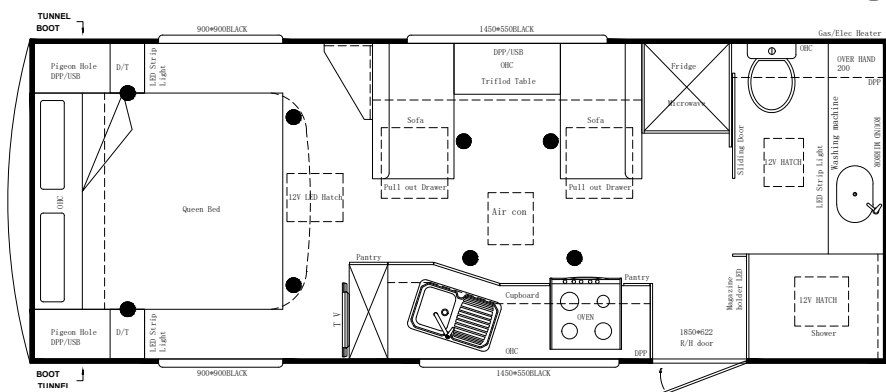

Toura 20ft 2 Centre Door (CD) Dinette

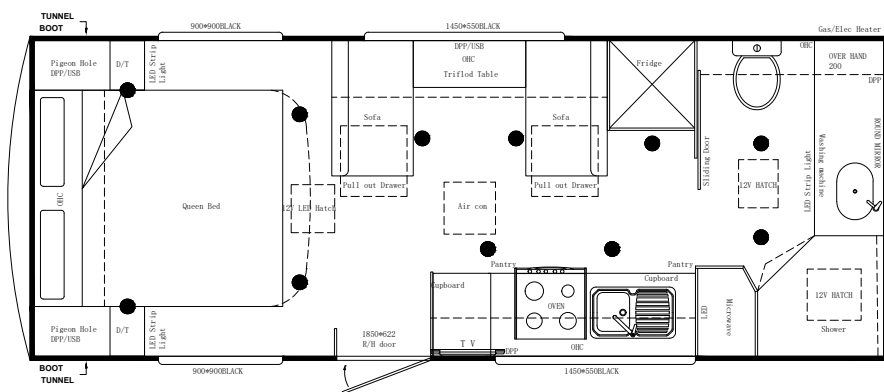

Toura 20ft 2 Centre Door (CD) L-Lounge

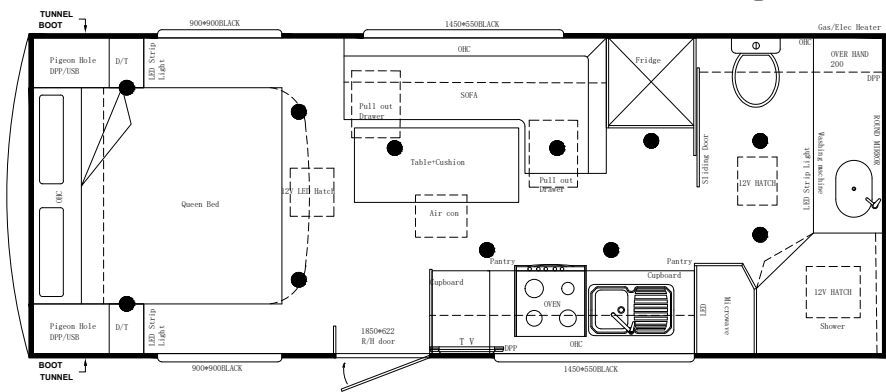

Toura 20ft 2 Rear Door (CD) Dinette

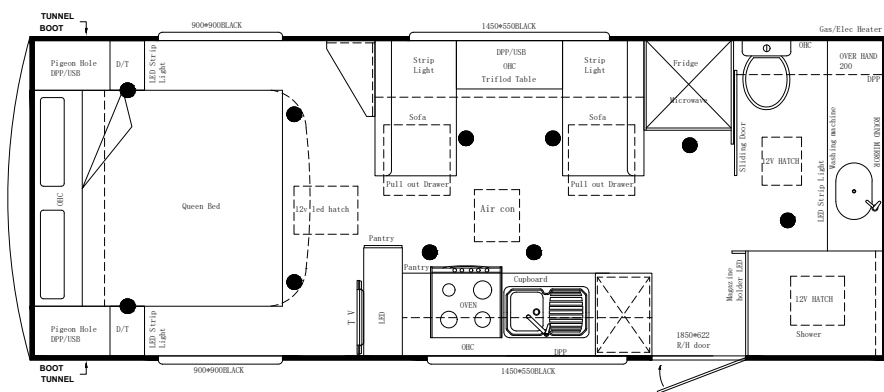

Toura 20ft 2 Rear Door (RD) L-Lounge

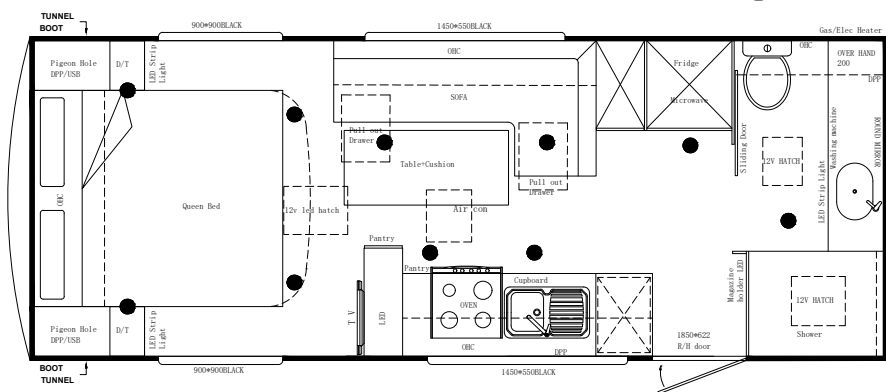

Layouts

Toura 22ft 2 Centre Door (CD) Dinette

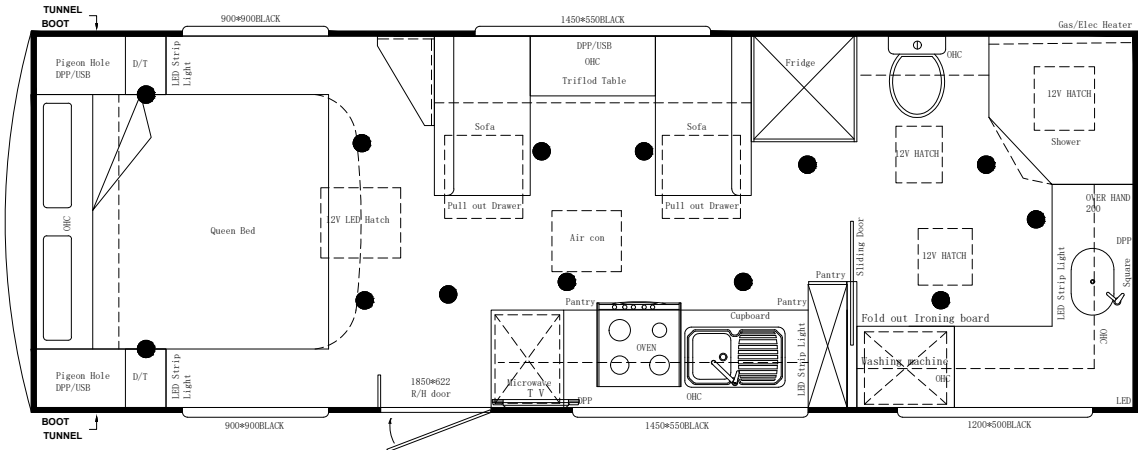

Toura 22ft 2 Rear Door (RD) Dinette Optional Sliding Door + Second TV

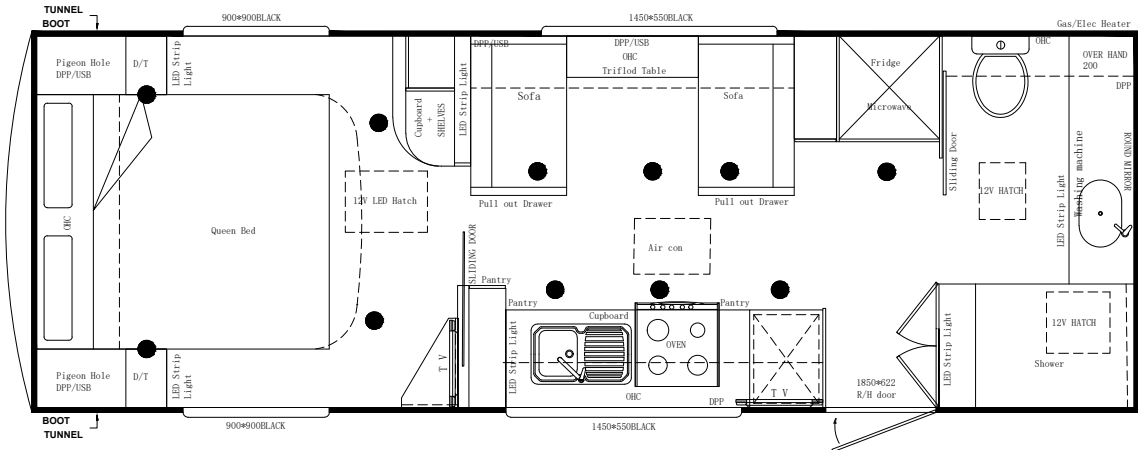

Toura 22ft 2 Centre Door (CD) Side Club Lounge

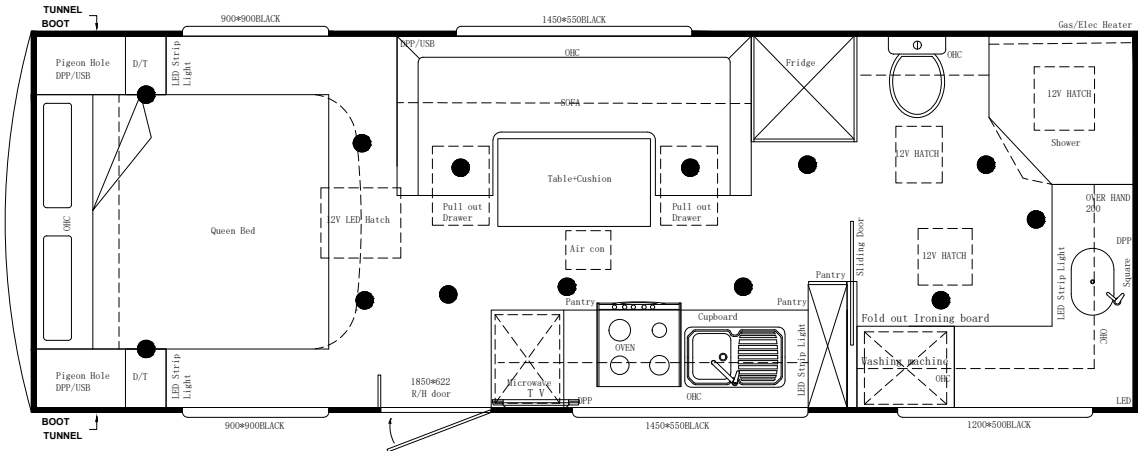

Toura 22ft 2 Rear Door (RD) Side Club Lounge Optional Sliding Door + Second TV

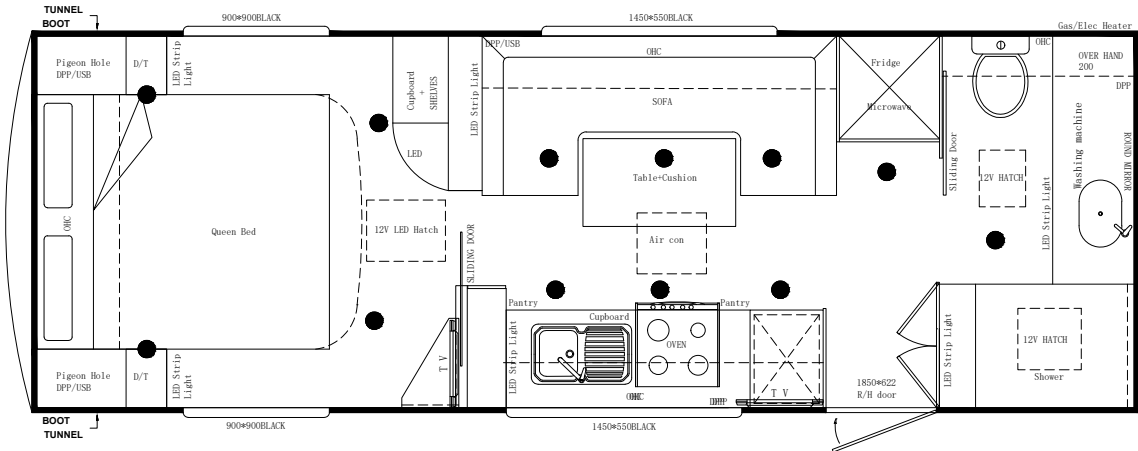

Toura 22ft 6 Rear Door (RD) Rear Club Lounge

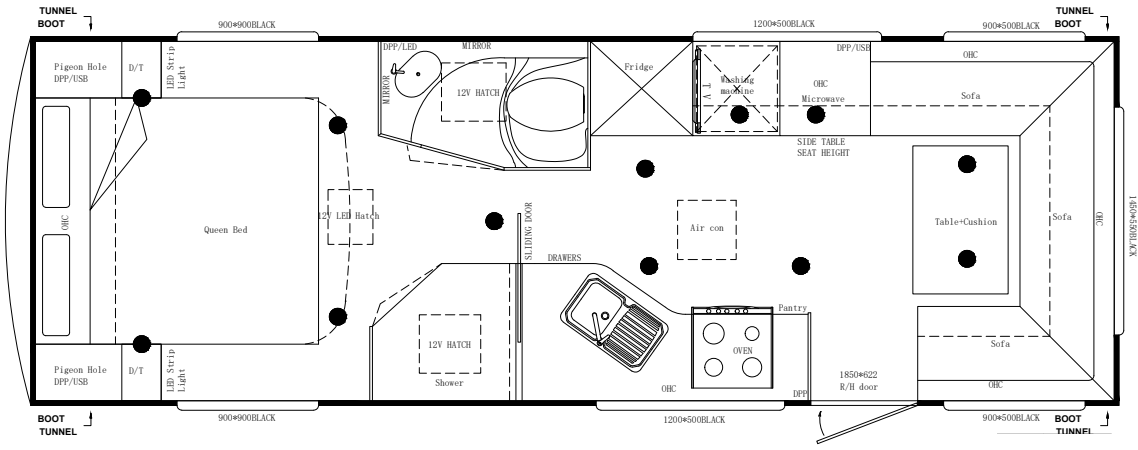

Layouts — Family Vans

Toura 20ft 2

Centre Door (CD)

Bunk

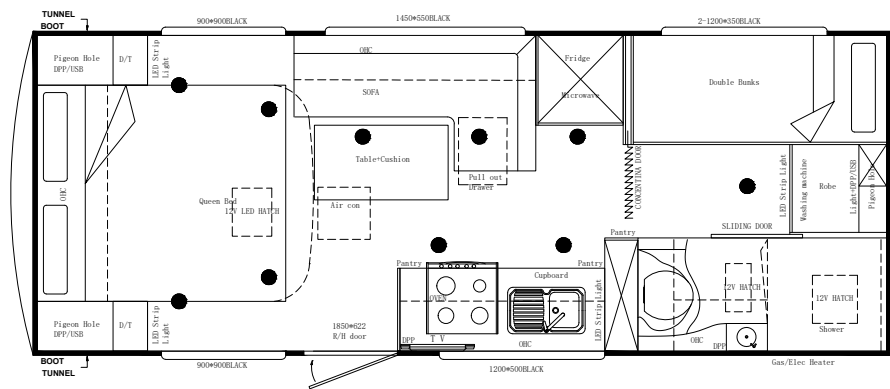

Toura 22ft 2

Centre Door (CD)

Bunk

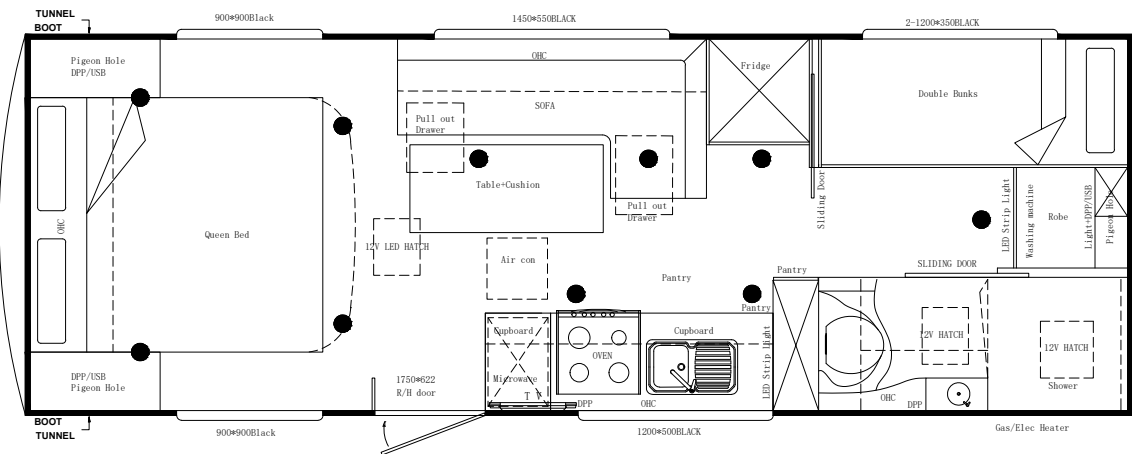

Note 1:
The tow ball and tare weights are only a guide and will change depending on accessories that are fitted to your van.

It is advisable to discuss this with your Millard Dealer covering your specific requirements.

Note 2:
Options are layout dependent and some options are not available on certain vans and should be discussed with your dealer

Key
• Standard
o Optional
- Not Available

Specifications — Family Vans

| Toura | 20ft2" | 22ft2" |
|---|-----------|-----------|
| Door Position | CD | CD |
| Standard Seating | L- Lounge | L- Lounge |
| Nominal Dimensions (mm) | | |
| External length | 6310 | 6910 |
| Internal Length | 6150 | 6750 |
| Total Length includes A Frame & Spare Wheel | 8555 | 9155 |
| External width (including Rollup Awning) | 2500 | 2500 |
| Internal width | 2285 | 2285 |
| Internal Height | 2030 | 2030 |
| Total Travel Height with AC (Indicative) | 2995 | 2995 |
| A - Frame to Chassis | 2015 | 2015 |
| Weights (kgs) | | |
| Tare Weight | 2650 | 2760 |
| ATM (kgs) | 3500 | 3500 |
| Carry Load or Payload (Approximate) | 850 | 740 |

Indicative weights, subject to change as dependent on the specification and options - See note 2

Indicative Height, subject to the wheel size, layout and load on the van axles/suspension.

| Construction | 20ft2" | 22ft2" |
|---|--------|--------|
| Hot Dip Galvanised Chassis | • | • |
| Aluminium Wall Frame | • | • |
| Full Piece Composite Roof | • | • |
| Insulation to Walls and Ceilings | • | • |
| Marine Ply Flooring | • | • |
| Aluminium Composite Panel | • | • |
| Extended Draw Bar | • | • |
| Preset Timber Blocks (Provision for Bike Rack) | • | • |
| Wheel Axle | Tandem | Tandem |
| CR52 Cruise Master 3.5T | • | • |
| Exterior | | |
| 15 inch wheels - Black with Inserts | • | • |
| 16inch wheels - Black with Inserts | o | o |
| Checker Plate - Black, approx 550mm on sides and back | • | • |
| Checker Plate - Silver or Charcoal | o | o |
| Aluminium Composite Panel - White | • | • |
| Aluminium Composite Panel - Silver or Charcoal | o | o |
| Corrugated Aluminium Cladding - White or Silver | o | o |
| Vinyl Decals Colours: Gold, Red, Blue, Silver,White | • | • |
| 2 x 95litre water Tanks | • | • |
| Provision for Grey Water Tank | • | • |
| Grey Water Tank (110 Litres) | o | o |
| Picnic Table | • | • |
| Mains Tap to A Frame & Mains Pressure | • | • |
| 2 x 9kg Gas Bottles | • | • |
| Double Battery Box (Single Battery 100AH) | • | • |
| Additional 100AH Battery | o | o |
| One Solar Panel with Regulator (160watts) | • | • |
| Additional Solar Panel (160watts) | o | o |
| External Awning | • | • |
| Annexe Lights | • | • |

Toura

| Toura | 20ft2" | 22ft2" |
|--|--------|--------|
| Gas Bayonet | • | • |
| External Speakers | • | • |
| External Power Point and TV Point | • | • |
| Entrance Door 1850mm | • | • |
| Tool Box with Sliders | • | • |
| Checker Plate Wheel Arches | • | • |
| Reversing Camera | • | • |
| Large Tunnel Boot | • | • |
| External Shower | o | o |
| External TV Point + Arm+ Locker | o | o |
| Internals | | |
| CNC Cabinetry | • | • |
| Telescopic Dining Table with Tic Cushion | • | • |
| Exclusive Upholstery designs and Fabrics | • | • |
| Full Size Bedhead and Map Holder | • | • |
| Pelmetrics (Std : bedroom windows + Above seating) | • | • |
| Dometic Ibis 4 Air Conditioner | • | • |
| Dometic RUC 6408X (Compressor Fridge 188L) | • | • |
| Dometic RMD10.5X5(3 Way Absorption Fridge - 175L Net) | o | o |
| Recessed Dometic 4 Gas Cooktop with Grill | o | o |
| Full Dometic Oven with Cooktop and Grill | • | • |
| Microwave | • | • |
| Slimline RangeHood | • | • |
| QFLOW Exclusive Front Loader Washing Machine | • | • |
| Winegard HD Antenna | • | • |
| 24" LED TV | • | • |
| Additional 24" LED TV | o | o |
| Provisional Wiring x 2 in Bedroom for Sirocco Fans | • | • |
| Sirocco Fans | o | o |
| Skylight Hatch with LED lighting (7000x500mm) | • | • |
| Sliding Door at Ensuite | • | • |
| Concertina Door at Bunks | • | NA |
| Sliding Door at Bunks | NA | • |
| Square mirror Frameless | • | • |
| 2 Bathroom Exhaust Hatches with LED | • | • |
| Safety | | |
| Breakaway Safety System | • | • |
| Fire Extinguisher | • | • |
| Smoke Alarm | • | • |
| Door - External 4 Pin lock with Security Screen | • | • |
| AL-KO ESC (Electronic Stability Control) | o | o |
| Fabric/Splash Board, Vanity, Kitchen Bench | | |
| Number of Colour Combinations | 7 | 7 |
| Dining/Seating Configuration | | |
| L- Lounge with one end foot rest and Tic Cushion | • | • |
| Family Bunk Van | | |
| Additional Bunk | o | o |
| Bunk Side : Right STD(Far Side/Drivers side) | • | • |
| Bunk Side : Left Side / Door Side Optional | o | o |
| External Access Hatch 893x228mm (under 1st Bunk Bed for Double Bunks only) | o | o |

15

Specifications

| Toura | 16ft9" | 17ft6" | 18ft2" | 18ft8" | 19ft6" | 20ft2" | 20ft2" | 22ft2" | 22ft2" | 22ft6" |
|------------------|----------|----------|----------|---------|---------|----------|-----------|---------|-----------|-----------|
| Door Position | CD | CD or RD | RD | RD | RD | CD or RD | CD or RD | CD | CD or RD | RD |
| Standard Seating | L-Lounge | L-Lounge | L-Lounge | Dinette | Dinette | Dinette | Side Club | Dinette | Side Club | Rear Club |

| NomiNal Dimensions (mm) | | | | | | | | | | |
|---|------|------|------|------|------|------|------|------|------|------|
| ExterNal length | 5310 | 5510 | 5710 | 5860 | 6110 | 6310 | 6310 | 6910 | 6910 | 7020 |
| InterNal Length | 5150 | 5350 | 5550 | 5700 | 5950 | 6150 | 6150 | 6750 | 6750 | 6860 |
| Total Length includes A Frame & Spare Wheel | 7555 | 7755 | 7955 | 8105 | 8355 | 8555 | 8555 | 9155 | 9155 | 9265 |
| ExterNal width (including Rollup Awning) | 2500 | 2500 | 2500 | 2500 | 2500 | 2500 | 2500 | 2500 | 2500 | 2500 |
| InterNal width | 2285 | 2285 | 2285 | 2285 | 2285 | 2285 | 2285 | 2285 | 2285 | 2285 |
| InterNal Height | 2030 | 2030 | 2030 | 2030 | 2030 | 2030 | 2030 | 2030 | 2030 | 2030 |
| Total Travel Height with AC (Indicative) | 2995 | 3060 | 3060 | 2995 | 2995 | 2995 | 2995 | 2995 | 2995 | 2995 |

| Weights (kgs) | | | | | | | | | | |
|-------------------------------------|------|------|------|------|------|------|------|------|------|------|
| Tare Weight | 2000 | 2250 | 2300 | 2390 | 2450 | 2525 | 2550 | 2660 | 2660 | 2700 |
| ATM (kgs) | 2500 | 2800 | 2800 | 3300 | 3300 | 3500 | 3500 | 3500 | 3500 | 3500 |
| Carry Load or Payload (Approximate) | 500 | 550 | 500 | 910 | 850 | 975 | 950 | 840 | 840 | 800 |

Indicative weights, subject to change as dependent on the specification and options - See note 2

Indicative Height, subject to the wheel size, layout and load on the van axles/suspension.

| Specification | • | Standard | o | Optional | | | | | | |
|---|--------|----------|--------|----------|--------|--------|--------|--------|--------|--------|
| Construction | 16ft9" | 17ft6" | 18ft2" | 18ft8" | 19ft6" | 20ft2" | 20ft2" | 22ft2" | 22ft2" | 22ft6" |
| Hot Dip Galvanised Chassis | • | • | • | • | • | • | • | • | • | • |
| Aluminium Wall Frame | • | • | • | • | • | • | • | • | • | • |
| Full Piece Composite Roof | • | • | • | • | • | • | • | • | • | • |
| Insulation to Walls and Ceilings | • | • | • | • | • | • | • | • | • | • |
| Marine Ply Flooring | • | • | • | • | • | • | • | • | • | • |
| Aluminium Composite Panel | • | • | • | • | • | • | • | • | • | • |
| Extended Draw Bar | • | • | • | • | • | • | • | • | • | • |
| Preset Timber Blocks (Provision for Bike Rack) | • | • | • | • | • | • | • | • | • | • |
| Wheel Axle | Single | Single | Single | Tandem | Tandem | Tandem | Tandem | Tandem | Tandem | Tandem |
| CR5 2 Cruise Master 2.5T | • | | | | | | | | | |
| CR5 2 Cruise Master 3.3T | | | | • | | | | | | |
| CR52 Cruise Master 3.5T | | | | o | • | • | • | • | • | • |
| XT Cruise Master 2.8T - Standard Arm | o | • | • | NA | NA | NA | NA | NA | NA | NA |

| Exterior | | | | | | | | | | |
|---|---|----|----|---|---|---|---|---|---|---|
| 15 inch wheels - Black with Inserts | • | NA | NA | • | • | • | • | • | • | • |
| 16inch wheels - Black with Inserts | o | • | • | o | o | o | o | o | o | o |
| Checker Plate - Black (550mm o nsides and back) | • | • | • | • | • | • | • | • | • | • |
| Checker Plate - Silver or Charcoal | o | o | o | o | o | o | o | o | o | o |
| Aluminium Composite Panel - White | • | • | • | • | • | • | • | • | • | • |
| Aluminium Composite Panel - Silver or Charcoal | o | o | o | o | o | o | o | o | o | o |
| Corrugated Aluminium Cladding - White or Silver | o | o | o | o | o | o | o | o | o | o |
| Vinyl Decals Colours: Gold, Red, Blue, Silver | • | • | • | • | • | • | • | • | • | • |
| 2 x 95litre water Tanks | • | • | • | • | • | • | • | • | • | • |
| Provision for Grey Water Tank | • | • | • | • | • | • | • | • | • | • |
| Grey Water Tank (110 Litres) | o | o | o | o | o | o | o | o | o | o |
| Picnic Table | • | • | • | • | • | • | • | • | • | • |

| Toura | 16ft9" | 17ft6" | 18ft2" | 18ft8" | 19ft6" | 20ft2" | 20ft2" | 22ft2" | 22ft2" | 22ft6" |
|---|--------|--------|--------|--------|--------|--------|--------|--------|--------|--------|
| Mains Tap to A Frame & Mains Pressure | • | • | • | • | • | • | • | • | • | • |
| 2 x 9kg Gas Bottles | • | • | • | • | • | • | • | • | • | • |
| Double Battery Box (Single Battery 100AH) | • | • | • | • | • | • | • | • | • | • |
| Additional 100AH Battery | o | o | o | o | o | o | o | o | o | o |
| One Solar Panel with Regulator (160watts) | • | • | • | • | • | • | • | • | • | • |
| AdditioNal Solar Panel (160watts) | o | o | o | o | o | o | o | o | o | o |
| External Awning | • | • | • | • | • | • | • | • | • | • |
| Annexe Light | • | • | • | • | • | • | • | • | • | • |
| Gas Bayonet | • | • | • | • | • | • | • | • | • | • |
| External Speakers | • | • | • | • | • | • | • | • | • | • |
| External Power Point and TV Point | • | • | • | • | • | • | • | • | • | • |
| Entrance Door 1850mm | • | • | • | • | • | • | • | • | • | • |
| Tool Box with Sliders | • | • | • | • | • | • | • | • | • | • |
| Checker Plate Wheel Arches | • | • | • | • | • | • | • | • | • | • |
| Reversing Camera | • | • | • | • | • | • | • | • | • | • |
| Large Tunnel Boot | • | • | • | • | • | • | • | • | • | • |
| External Shower | o | o | o | o | o | o | o | o | o | o |
| External TV Point + Arm+ Locker | o | o | o | o | o | o | o | o | o | o |

| Internals | | | | | | | | | | |
|--|----|----|----|----|----|-----------|----|-----------|-----------|----|
| CNC Cabinetry | • | • | • | • | • | • | • | • | • | • |
| Tri Fold Dining Table | NA | NA | NA | • | • | • | NA | • | NA | NA |
| Telescopic Dining Table with Tic Cushion | • | • | • | o | o | o | • | o | • | • |
| Exclusive Upholstery designs and Fabrics | • | • | • | • | • | • | • | • | • | • |
| Full Size Bedhead and Map Holder | • | • | • | • | • | • | • | • | • | • |
| Pelmets (Std : bedroom windows + Above seating) | • | • | • | • | • | • | • | • | • | • |
| Dometic Ibis 4 Air Conditioner | • | • | • | • | • | • | • | • | • | • |
| Dometic RUC 640BX (Compressor Fridge 188L) | • | • | • | • | • | • | • | • | • | • |
| Dometic RMD10.5XS (3 Way Absorption Fridge 175L) | o | o | o | o | o | o | o | o | o | o |
| Recessed Dometic 4 Gas Cooktop with Grill | o | o | o | o | o | o | o | o | o | o |
| Full Dometic Oven with Cooktop and Grill | • | • | • | • | • | • | • | • | • | • |
| Microwave | • | • | • | • | • | • | • | • | • | • |
| Slimline Rangehood | • | • | • | • | • | • | • | • | • | • |
| QFLOW Exclusive Front Loader Washing Machine | • | • | • | • | • | • | • | • | • | • |
| Winegard HD Antenna | • | • | • | • | • | • | • | • | • | • |
| 24" LED TV | • | • | • | • | • | • | • | • | • | • |
| Additional 24" LED TV | o | o | o | o | o | o | o | o | o | o |
| Provisional Wiring x 2 in Bedroom for Sirocco Fans | • | • | • | • | • | • | • | • | • | • |
| Sirocco Fans | o | o | o | o | o | o | o | o | o | o |
| Skylight Hatch with LED lighting (450x400mm) | • | • | • | NA | NA | NA | NA | NA | NA | NA |
| Skylight Hatch with LED lighting (7000x500mm) | NA | NA | NA | • | • | • | • | • | • | • |
| Additional Hatch in Ensuite | o | o | o | o | o | o | o | o | o | o |
| Sliding Door at Ensuite | • | • | • | • | • | • | • | • | • | • |
| Ensuite - Round Mirror | NA | • | • | NA | • | • | • | • | RD | NA |
| Square Mirror Frameless | • | NA | NA | • | NA | NA | NA | NA | CD | • |
| 2 Bathroom Exhaust Hatches with LED | • | • | • | • | • | • | • | • | • | • |
| Bedroom Package (Sliding door, Wardrobe, Sirocco Fans) | NA | NA | NA | NA | NA | o RD Only | NA | o RD Only | o RD Only | NA |

Specifications

[illegible]

| Fabric/Splash Board, Vanity, Kitchen Bench | | | | | | | | | |
|--|---|---|---|---|---|---|---|---|---|
| Number of Colour Combinations | 7 | 7 | 7 | 7 | 7 | 7 | 7 | 7 | 7 |

| Dining/Seating Configuration | | | | | | | | | | |
|---|----|----|----|----|----|----|----|----|----|----|
| L- Lounge with one end foot rest and Tic Cushion | • | • | • | o | o | o | NA | NA | NA | NA |
| Dinette / Café with End Foot Rests | NA | NA | NA | • | • | • | NA | • | NA | NA |
| Side Club Lounge with End Foot Rests & Bed Conversion | NA | NA | NA | NA | NA | NA | • | NA | • | NA |
| Rear Club Lounge | NA | NA | NA | NA | NA | NA | NA | NA | NA | • |
| Single Beds | o | o | o | o | o | o | NA | NA | NA | NA |

Note 1:
The tow ball and tare weights are only a guide and will change depending on accessories that are fitted to your van.

It is advisable to discuss this with your Millard Dealer covering your specific requirements.

Note 2:
Options are layout dependent and some options are not available on certain vans and should be discussed with your dealer

18

Millard Caravans

Key

| | |
|---|---------------|
| • | Standard |
| o | Optional |
| - | Not Available |

Optional Extras

| Black Pack Option (Inclusions Noted) | |
|--------------------------------------|---------------------------------|
| | Matt Black Kitchen Sink |
| | Matt Black Round Basin |
| | Matt Black Shower Rail and Head |
| | Matt Black Double Towel Rack |
| | Matt Black Toilet Roll Holder |
| | Black Handles |

| Internal Options |
|--|
| Additional Bunk |
| Single Beds Configuration |
| Bunk Van - Upholstered Ladder and Bunk open side panels |
| Telescopic Dining Table with Tic Cushion |
| Bedroom Package (Sliding door, Wardrobe, Sirroco Fans x 2) |
| |
| |
| |

| Plumbing |
|--|
| Grey Water Tank (110 litres) |
| Webasto AT2000 Diesel Heater with 12 litre Tank |
| Truma Vario Gas Heater |
| Dometic Slide Out Kitchen |
| Full Cooker-CookTop, Grill and Oven |
| Non Return Valves at Drainage Points |
| Truma AquGo HWS |
| Drink Water Filter |
| External Shower (Hot and Cold) |
| Dometic Airtronic D2 Diesel Heater |
| Swift801Yr Swivel Slide Out BBQ |
| Truma Combi D6 Diesel Heater WMK Black |
| Camec 4kg Front Loader Washing Machine including Vanity Change |
| Camec 240V Dryer - 3.2kgs |
| Dometic Fridge RUC6408x (Compressor 188 Litres) |
| |

Price on Application
Lithium Batteries / Management System
Suspension Upgrade

Toura

| External Options |
|---|
| Bike Rack |
| D035 Coupling |
| Stone Guard Protector |
| Jerry Can Holders |
| AL-KO ESC (Electronic Stability Control) |
| Aluminium Corrugated Cladding (Whiteor Silver) |
| Pressure Hatch / Scupper Vent |
| Mesh on the A- Frame |
| Heavy Duty 3 Arm Bumper Bar |
| Wheel Upgrade to 16" |
| Front Window with Cover |
| 893x228mm Access Hatch (under 1st Bunk Bed for Double Bunks only) |
| Skylight Hatch with LED Lighting (Ensuite) |
| Underslung Wheel Carrier |
| Dometic Dust Hatch |
| 16" Wheels |

| Electrical |
|--|
| Additional Solar Panel and Regulator 160 watts |
| 12V Sirrocco Fans |
| Additional 12V Power Point Outlet |
| Additional External Power Point |
| External TV Point + Arm + Locker |
| Additional Internal Double Power Point |
| Extra Annexe Light |
| Additional Battery |
| Additional Internal TV Point +TV+Bracket |
| External Bar Light |
| Anderson Plug |
| Sphere Satellite System |
| Additional LED Downlights |
| BM Pro Charging and Monitoring System |
| |

19



3 Heald Rd, Ingleburn
NSW 2565

02 9829 2055

info@millardrv.com.au

Your ticket to *freedom*

Your Millard Caravans Dealer:

